

CIRCULAR ECL

The max strength (in kg) is indicated at **Air gap Zero**. The electromagnet's surface is in contact with the iron's one.
The surface of the iron piece should be created with the minimal roughness. The max strength of attraction is obtained with an iron matching part, 10 mm thick.

The electromagnets are suitable to move and keep Iron pieces, for applications in complex systems, for positioning and robotization.
Execution standard at 24 V DC. Other voltages available on request. Class F insulation. Cable Output power/ lower side.

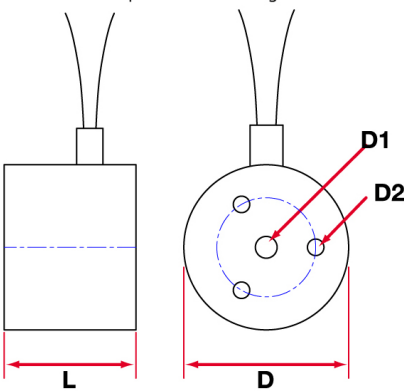

Picture.1

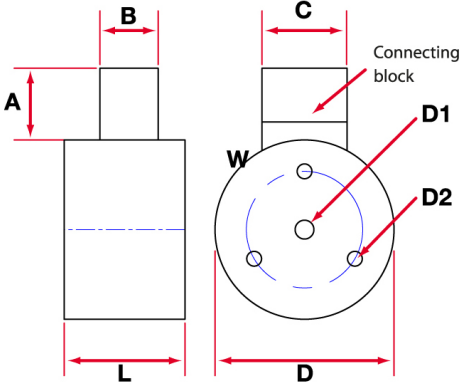

Picture.2 2 poles connector

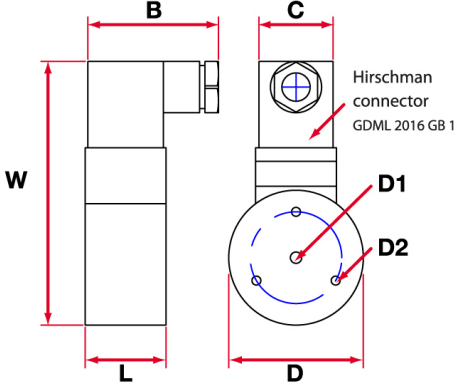

Figura.3 Hirschman connector

TYPE	D	L	A	B	C	D1	D2	CABLE LENGTH (RED+BLA CK)	Consumpti on W	Strength MAX (KG)	Weight kg
ECL0.000000.20C					20	18	/	/	/	M4	M3
ECL0.000000.25C					25	20	/	/	/	M4	M3
ECL0.000000.30C					30	24	/	/	/	M5	M3
ECL0.000000.40C					40	27	16	13	19	M5	M4
ECL0.000000.50C					50	30	16	13	19	M5	M4
ECL0.000000.50C.240 (EXEC. 240 V)					50	30	16	50	30	M5	M4
ECL0.000000.65C					65	35	16	13	/	M8	M5
ECL0.000000.65C.240 (EXEC. 240 V)					65	35	16	50	30	M8	M5
ECL0.000000.80C					80	38	16	13	19	M8	M6
ECL0.000000.100C					100	43	16	13	19	M10	M6

All the measures are in millimeters. Oher sizes and shapes by request.