

ELECTRO-PERMANENT EMP

The max strength (in Kg) is indicated at **Air gap Zero**. The electropermanent's surface is in contact with the iron's one. The surface of the iron piece is created with the minimal roughness. Its thickness is 10 mm.

At the same thickness and roughness we can obtain decreasing magnetic forces with Iron (Fe 35), Steel 60, Malleable Cast Iron, Cast Iron and Steel quick.

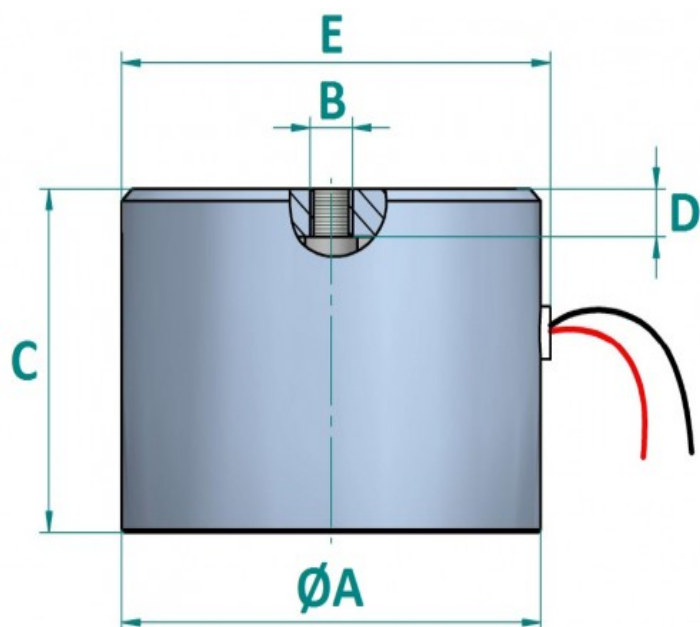

TYPE	A	B	C	D	E	MAX STRENGTH (KG)	Weight kg
EMPP.000000.V P-20	20	M3	25	6	26	3,97	0,040
EMPP.000000.V P-30	30	M4	32.5	10	35.2	18.4	0,13
EMPP.000000.V P-40	40	M5	42	8	42.7	28	0,28
EMPP.000000.V P-50	50	M5	42.8	6	52.5	62	0,44
EMPP.000000.V P-65	65	M8	45	10	67	124.4	0,74
EMPP.000000.V P-100	100	M10	67	10	102	230	3,00
EMPP.000000.V P-150	150	M16	65	15	152	225	7,10

All the measures are in millimeters.

The strength of attraction is purely indicative and it could be different depending on the type of application and assembly.