

MANUAL CONTROL IFND

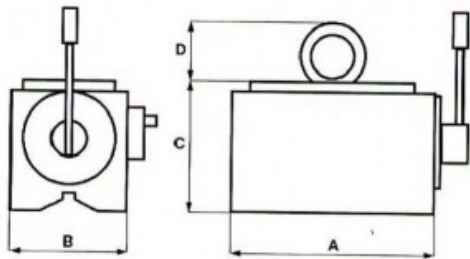

Magnetic lifters are suitable for lifting bars, rounds, sheets, moulds, beams or other pieces of iron. Being made with permanent magnets, they represent the maximum in the safety of lifting, as they do not detach the piece until after the lever has been operated. They have the advantage of being able to move the pieces quickly and avoiding slinging with ropes or chains. Please refer to our instruction manual.

CODE	Model	Weight Kg	A	B	C	D
SL10.000003.IFND1 00	IFDN100	4	103	67	70	81

All the measures are in millimeters. Other sizes and shapes by request.